

SETTING OUT				
REF.	TYPE	COVER LEVEL (m)	EASTING	NORTHING
S1	RING SOAKAWAY	12.15	487844.206	104163.425
S2	RING SOAKAWAY	12.15	487839.956	104169.237
S3	RING SOAKAWAY	12.30	487835.705	104175.048
S4	RING SOAKAWAY	12.60	488054.858	104178.897
G17	ROAD GULLY	11.91	488040.651	104172.017
G26	ROAD GULLY	11.76	487959.978	104140.761
G27	ROAD GULLY	11.80	487977.417	104141.746
G28	ROAD GULLY	11.98	488035.779	104168.894

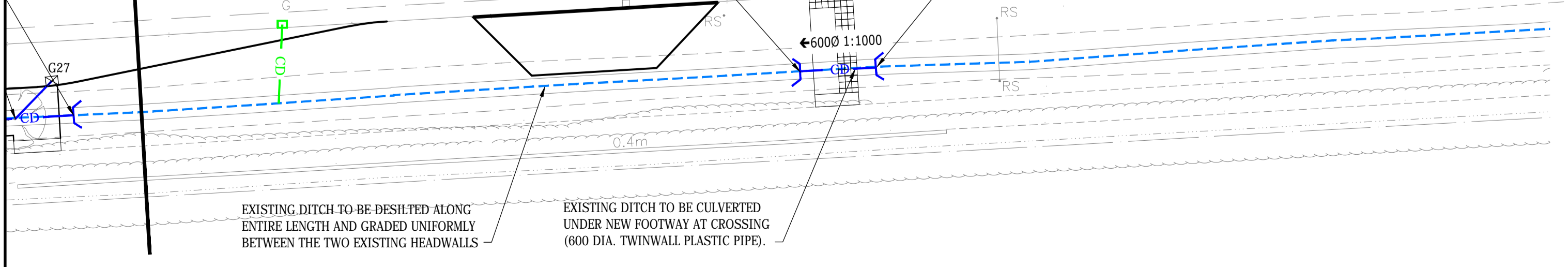
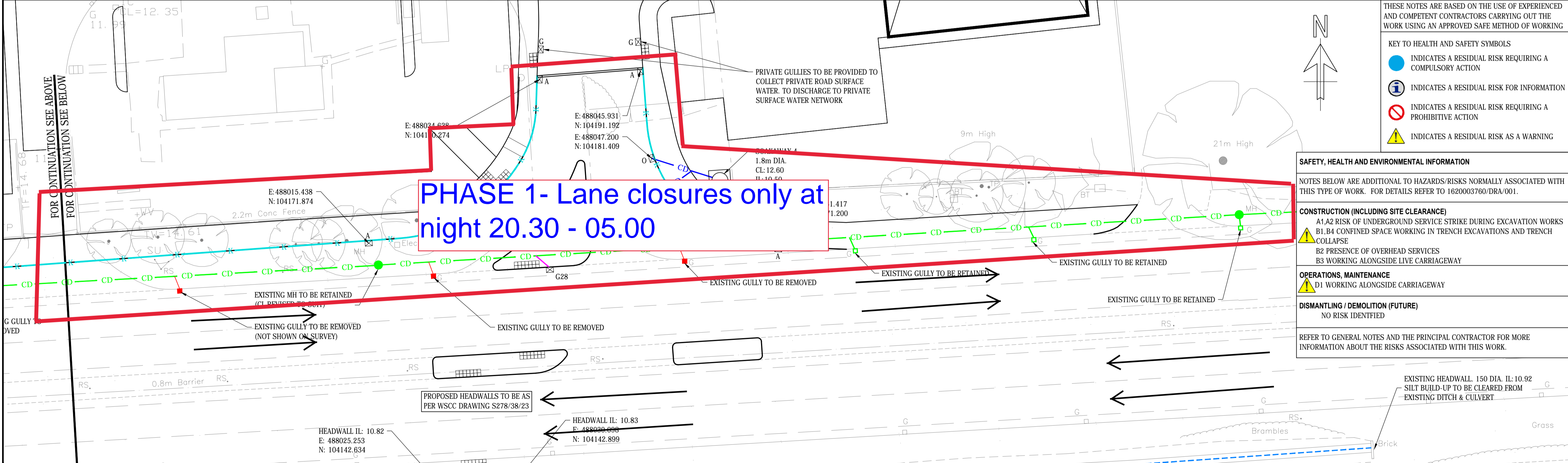
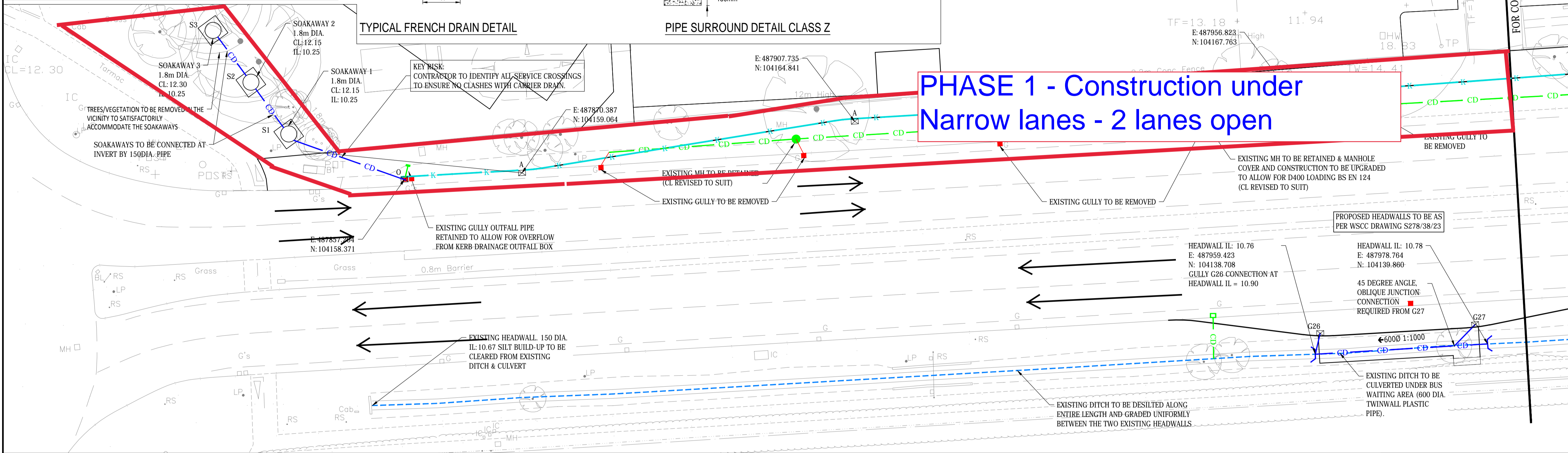

SOAKAWAY SCHEDULE								
SOAKAWAY NO.	CATCHMENT AREA (m ²)	SOAKAWAY COVER LEVEL (m)	SOAKAWAY BASE LEVEL (m)	SOAKAWAY RING DIA. (m)	PIT SIZE (m)	INCOMING INVERT (m)	EFFECTIVE DEPTH (m)	TOTAL DEPTH (m)
SOAKAWAY 1	*	12.15	10.25	1.80	2.50 x 2.50	11.23	0.98	1.78
SOAKAWAY 2	*	12.15	10.25	1.80	2.50 x 2.50	11.23	0.98	1.78
SOAKAWAY 3	*	12.30	10.25	1.80	2.50 x 2.50	11.23	0.98	1.78
SOAKAWAY 4	410	12.60	10.50	1.80	2.50 x 2.50	11.00	0.50	2.10

SOAKAWAY NOTE:
* INLINE SOAKAWAYS 1, 2 & 3 COMBINED CATCHMENT (NEW PAVEMENT TOTAL IMPERMEABLE AREA) = 1,640m²

- COPYRIGHT RAMBOLL UK LIMITED. ALL RIGHTS RESERVED. THIS DOCUMENT IS ISSUED FOR THE PARTY WHO COMMISSIONED IT AND FOR THE SPECIFIC PURPOSES CONNECTED WITH THE PROJECT ONLY. IT SHOULD NOT BE RELIED UPON BY ANY OTHER PARTY OR USED FOR ANY OTHER PURPOSE. RAMBOLL ACCEPTS NO RESPONSIBILITY OR LIABILITY WHICH MAY ARISE FROM RELIANCE OR USE OF THIS DOCUMENT OR THE DATA CONTAINED HEREIN BY ANY OTHER PARTY OR FOR ANY OTHER PURPOSE.
- Notes
- DO NOT SCALE FROM THIS DRAWING.
 - ALL DIMENSIONS ARE METRES U.N.O.
 - ALL LEVELS ARE IN METRES ABOVE ORDNANCE DATUM U.N.O.
 - THIS DRAWING IS TO BE READ IN CONJUNCTION WITH ALL RELEVANT ARCHITECTS AND ENGINEERS DRAWINGS AND SPECIFICATIONS.
 - THE CONTRACTOR IS TO ENSURE THAT ALL BURIED SERVICES ARE LOCATED PRIOR TO CARRYING OUT ANY EXCAVATION.
 - THE POSITION & LEVEL OF ALL EXISTING DRAINAGE IS TO BE SURVEYED BY THE CONTRACTOR & RESULTS PROVIDED TO THE ENGINEER PRIOR TO ANY WORK COMMENCING.
 - ALL WORKS TO BE CARRIED OUT IN ACCORDANCE WITH LOCAL WATER AUTHORITY, SEWERS FOR ADOPTION (LATEST EDITION), THE ENVIRONMENT AGENCY, LOCAL COUNCIL & THE SPECIFICATION FOR HIGHWAYS WORKS (LATEST EDITION).
 - TRAFFIC SIGNAL DESIGN BY "TELENT".
 - LIGHTING DESIGN BY "SSE".
 - LEVEL TEXT REMOVED FROM TOPO SURVEY FOR CLARITY.
 - REFER TO THE FOLLOWING DRAWINGS FOR DETAILED INFORMATION:
 - 0000 SERIES - LOCATION PLAN
 - 0100 SERIES - GENERAL ARRANGEMENTS
 - 0200 SERIES - SITE CLEARANCE
 - 0400 SERIES - ROAD RESTRAINTS
 - 0500 SERIES - DRAINAGE PLAN
 - 0700 SERIES - PAVEMENT & KERBS
 - 1200 SERIES - ROAD MARKINGS & SIGNS
 - 0101 SERIES - HIGHWAYS LONG SECTION
 - 0102 SERIES - HIGHWAYS CROSS SECTIONS

- KEY
- PROPOSED DRAINAGE
- PROPOSED ROAD GULLY
 - PROPOSED LATERAL CONNECTION (1500 UNLESS OTHERWISE STATED)
 - PROPOSED CARRIER DRAIN
 - PROPOSED MANHOLE CHAMBER
 - PROPOSED FRENCH DRAIN
 - PROPOSED SOAKAWAY
 - HEADWALL, AS PER WSSC STANDARD DETAIL DRAWING S278/38/23
 - PROPOSED KERB DRAIN, AS PER WSSC STANDARD DETAIL DRAWING S278/38/02
 - PROPOSED KERB DRAIN ACCESS POINT
 - PROPOSED KERB DRAIN OUTLET POINT
- EXISTING DRAINAGE
- EXISTING 150 DIA. CARRIER DRAIN
 - EXISTING MANHOLE TO BE RETAINED (COVER LEVELS REVISED TO SUIT)
 - EXISTING GULLY TO BE RETAINED
 - EXISTING CARRIER TO BE REMOVED
 - EXISTING GULLY TO BE REMOVED
 - EXISTING DITCH
- NOTE:
FOR CONSTRUCTION DETAILS REFER TO WEST SUSSEX COUNTY COUNCIL SECTION 278/38 HIGHWAY AGREEMENT STANDARD DETAILS S278/38/00 TO S278/38/27.

C01	APPROVED FOR CONSTRUCTION	05/06 2018	NJ	MRD
Rev	Description	Date	By	App
			Clk	

APPROVED FOR CONSTRUCTION

BOGNOR ROAD S278

RAMBOLL

tel 023 8081 7500 fax 023 8081 7600 southampton@ramboll.co.uk www.ramboll.co.uk

DRAINAGE PLAN

Project No:	Scale (HAI):	Drawn:	Date:
1620003760	1:250	JAC	FEB.18
Drawing No:			
RAM-0500-DR-CR-00001			